



We're at the heart of document imaging.

Kodak i800 Series Scanners



With a legacy of imaging experience and innovative technologies, Kodak is at the heart of a key infoimaging industry—document imaging. Kodak pioneered the process of transforming huge volumes of paper into digital information through high-speed scanning, and the flagship KODAK i800 Series Scanners expertly blend high-tech features and real-world benefits. The ultimate triumph of the KODAK i810, i820, i830 and i840 Scanners is that they deliver the high-value benefits that customers need most: productivity, versatility and reliability.

Productivity. It's absolutely essential for high-volume applications and KODAK i800 Series Scanners deliver it. Our exclusive paper handling technology easily accepts documents of different sizes, weights and types, and enables stack after stack of documents to fly through our scanners at speeds up to 160 pages per minute - day in and day out.

Versatility. Another must-have for massive workloads with production spikes, multiple batch types and the need for workflow optimisation on the fly. With KODAK i800 Series Scanners, versatility is inherent. An upgrade path is designed in, which means you can add speed or colour/greyscale scanning right at your site, with minimal downtime.

Reliability. It's a critical component for any efficient high-volume application. And you get it in multiple ways with KODAK i800 Series Scanners. Robust features like advanced image processing and renowned paper handling allow you to reliably zip through your most challenging workloads - today, next week, next month and next year. Plus KODAK Service & Support is just a phone call away, helping to maximise your uptime.

And KODAK Capture Software helps increase productivity, versatility and reliability in your scanning operation. It enables you to capture images, extract and index data from images, and output image file formats supporting the leading document and enterprise content management systems. In short, Capture Software helps automate your workflow for maximum performance.

Proven document imaging performance from the world leader in imaging - for your high-volume application. That's what KODAK i800 Series Scanners are all about. If you think they look good on paper, wait until you see them in action.



Features that redefine productivity.

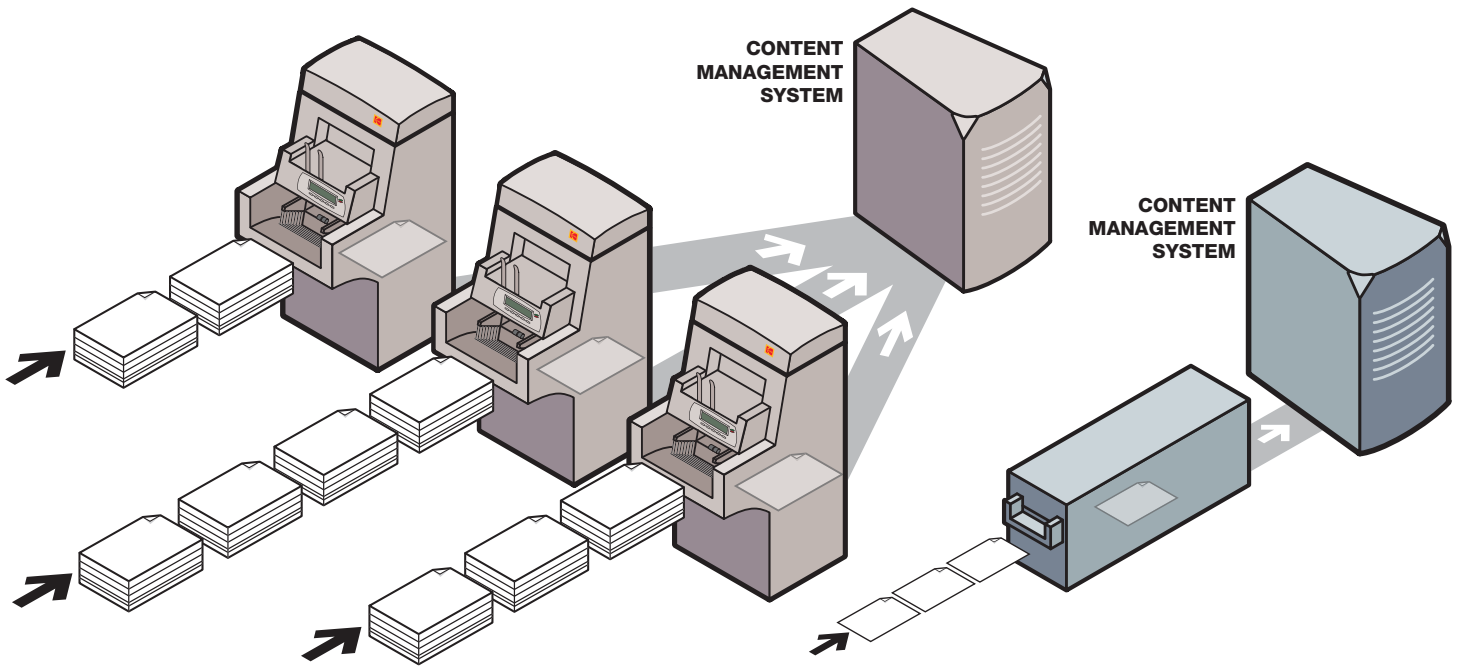

Take Advantage of Kodak's Price/Performance - Using multiple KODAK i800 Series Scanners minimises downtime and allows several applications to run simultaneously, making information available faster.

Competitive Configuration - A single, higher-cost scanner limits workflow versatility and slows information availability.

Advanced image processing.

Great image quality and performance delivered to virtually any document management application at high speed. Advanced image processing in the KODAK i800 Series Scanners minimises presorting and post-image processing, which helps maximise your usable image throughput. Here's why:

Perfect Page Scanning with iThresholding*

- Delivers exceptional image quality, even on challenging documents with low contrast, with readability as good as—and sometimes better than—the original document.
- Produces deskewed images, excellent OCR/ICR read rates and, in many cases, smaller file sizes.
- Multiple cropping options allow you to automate scanning efficiencies such as black border removal and scanning of a select image area for forms processing.



Competitive scanner

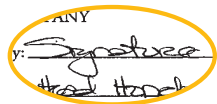

Perfect Page Scanning with iThresholding, only from Kodak

Five image output options**

Support virtually any workflow and supply images to almost any document management software:

- bitonal only
- simultaneous bitonal and colour
- colour only
- simultaneous bitonal and greyscale
- greyscale only

Fulfill all kinds of business needs such as forms processing, web presentation, key from image, regulatory compliance, archiving and more.

Electronic colour dropout

enhances forms processing by allowing the scanner to ignore irrelevant background colour and capture only the information you need.

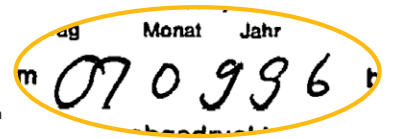
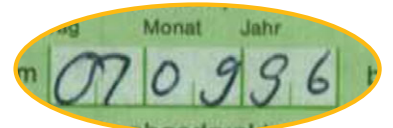

*Some document capture applications do not utilise the full benefits of iThresholding

**Colour and greyscale output available on the KODAK i820 and i840 Scanners.

Unique patch code

Allows your KODAK i800 Series Scanners to automatically switch "on the fly" between bitonal and colour/greyscale** scanning.

SurePath paper handling enables virtually uninterrupted workflow.

Proven benefits that help you reduce costs, beat demanding schedules and satisfy customers are a result of a feature set that lets you scan just about any document. From delicate onionskin to heavy cardstock, in almost any condition - you get consistent speed and accuracy that keeps productivity up and operating costs down.

- Kodak's renowned **automatic document** feeder accepts papers of mixed sizes and weights.
- The feeder also adjusts to enable **left, centre or right feeding**. This exclusive feature makes document prep easier and increases workflow efficiency.
- The operator-adjustable **QuickSet elevator** handles up to 1,000 sheets of paper in various sizes and can be set for various batch heights.
- Combines several methods of **multi-feed detection**, including ultrasonic technology, to reliably check for overlaps and misfeeds.
- Delivers virtually **jam-free operation** with a transport architecture that keeps constant control of the documents being scanned.
- **Manual feeder accessory** allows you to feed documents sheet by sheet.

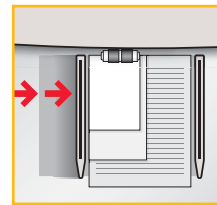

LEFT FEEDING

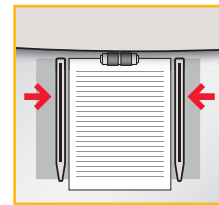

CENTRE FEEDING

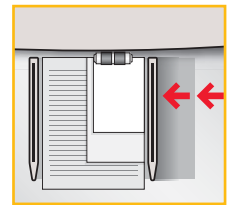

RIGHT FEEDING

Advanced indexing options for efficient image management.

A variety of image indexing level options provide multiple ways of organising information for easy retrieval. You can index images by level, which enables an advanced document image hierarchy for efficient information access. The scanner can automatically assign a sequential image address to the scanned documents at the batch, document or page level. Use of standard patch code sheets automates the changing of image address levels during scanning.

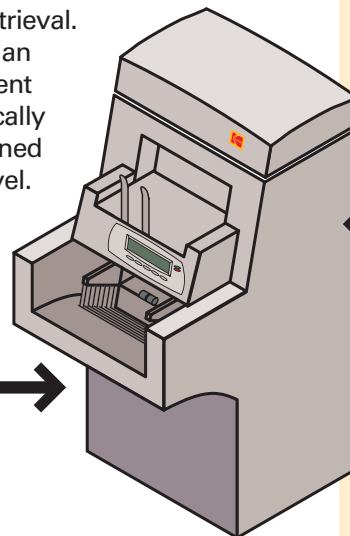
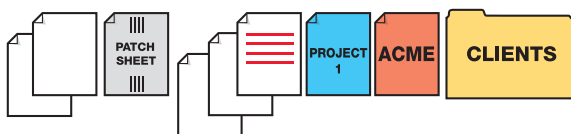

A document imprinter allows you to print a unique document control number on each page, even when multiple scanners are in use.



File	Options	Help
C:\2005\clients\Acme		001.00.000
C:\2005\clients\Acme\Project 1		001.01.000
C:\2005\clients\Acme\Project 1		001.01.001
C:\2005\clients\Acme\Project 1		001.01.002
C:\2005\clients\Acme\Project 1		001.01.003
C:\2005\clients\Acme\Project 2		001.02.000
C:\2005\clients\Acme\Project 2		001.02.000

This enables high confidence and versatility in index data capture for image retrieval, verification and auditing.

KODAK Service & Support makes sure your uptime stays up.

As one of the largest and most experienced service organisations in the document imaging industry, KODAK Service & Support provides peace-of-mind coverage with more than 2,000 highly trained and certified field engineers worldwide. Plus a global network of parts and distribution, exceptional on-site and help desk service, and a variety of service plans and options to fit the way you work. And it all comes with customer satisfaction ratings that are consistently above 95%. With KODAK Service & Support, the help you need is always close at hand.

Scan with confidence

In today's scanning environments, the need for productivity, versatility and reliability has never been greater. And the answer has never been more obvious. KODAK INNOVATION SERIES Scanners are the choice for businesses wanting to control costs and satisfy customers. Make a KODAK product purchase decision today, and improve your ability to capture, manage, archive and deliver your critical business information.



Height: 124 cm
Width: 66 cm
Depth: 127 cm
Weight: <204 kg



We're here for you.
Kodak Service & Support



Innovation you can count on™

© Eastman Kodak Company, 2005.
Kodak and Innovation Series are trademarks of Eastman Kodak Company.
A-5597 CAT No. 113 2414
Printed in Australia 9/05

Specifications

Recommended daily volume	Unlimited (typical document volumes range from 12,000 to 60,000 pages per 8-hour shift)					
Throughput speeds (pages per minute, landscape, A4)	at 200 dpi		at 300 dpi		at 400 dpi	
		Bitonal	Colour/Grey	Bitonal	Colour/Grey	Bitonal
	i810:	120	n/a	80	n/a	45
	i820*:	120	120	80	n/a	45
	i830:	160	n/a	106	n/a	60
i840*:	160	160	106	106**	60	
* Rated speeds for i820 and i840 Scanners are also valid for simultaneous output of bitonal and colour, or bitonal and greyscale, images						
** Speeds at this setting may vary based on host PC system limitations						
Scanning technology	Dual Tricolor Plus CCD Greyscale output bit depth is 256 levels (8-bit) Colour capture bit depth is 40-bit (10 bits per red, green, blue and black channels) Colour output bit depth is 24-bit					
Optical resolution	300 dpi					
Illumination	Long-life fluorescent lamps (operator replaceable)					
Output resolution	Bitonal: 200–400 dpi Colour/Greyscale: 100–300 dpi					
Maximum document size	305 x 768 mm					
Minimum document size	64 x 64 mm					
Paper thickness and weight	50 to 200 g/m ²					
Feeder	1,000-sheet QuickSet elevator with an auto-reset mechanism for accommodating variable batch sizes					
Multi-feed detection	3-D multi-feed detection with ultrasonic technology					
Connectivity	Wide Ultra SCSI-2 with LVDS					
Bundled software	TWAIN and ISIS drivers					
Imaging features (in the scanner)	Perfect Page Scanning with iThresholding, autocrop, aggressive crop, deskew, electronic colour dropout, halftone removal, noise removal, zone processing, toggle patch					
On-board compression	CCITT Group III-1D, 2D or IV					
File format outputs (from bundled drivers)	JPEG (for colour and greyscale images) TIFF (for bitonal images)					
Electrical requirements	100–127 VAC, 50/60 Hz, 6.5 A 200–240 VAC, 50/60 Hz, 3.5 A					
Power consumption	Idle: 246 W Running: 315 W typical, 760 W maximum					
Environmental factors	Operating humidity: 15–76% RH Operating temperature: 15–35° C (59–95° F)					
Acoustical noise (operator position sound pressure level)	Standby mode: <40 dB(A) Operating mode: <61 dB(A)					
Recommended PC config.	PENTIUM IV 2.4 GHz processor with 512 MB RAM					
Supported operating systems	WINDOWS 98SE, Me, NT, 2000, XP					
Approvals and product certifications	UL 1950 3rd Edition, CAN/CSA C22.2 No. 950-95, TUV EN60950, EN 55024, EN 55022 Class A, CE Mark, FCC Part 15 Class A, Canada ICES-003 Class A, Taiwan CNS13438 Class A, CISPR22 Class A, VCCI Class A, C-Tick Mark, AS/NZ 3548 Class A, EN 61000-3-2 Powerline Harmonics, EN 61000-3-3 Flicker					
Consumables available	Feeder consumables kits, white imaging lamps, imaging guide set, calibration targets, printer ink cartridges, printer ink cartridge carrier, printer ink blotters, staticide wipes, roller cleaning pads, transport cleaning sheets					
Accessories	Ultra-lightweight feed module, manual feeder, input extender, output extender					

Specifications subject to change without notice. Throughput speeds may vary depending on your choice of driver, application software, operating system and PC.

CONTACT INFORMATION

EASTMAN KODAK COMPANY. Document Imaging, Rochester, New York 14650 +1-800-944 6171
KODAK (AUSTRALASIA) PTY. LTD. Document Imaging, North Ryde NSW 2113, AUSTRALIA +61-2-9870-4224
KODAK (CHINA) INVESTMENT COMPANY LIMITED. Document Imaging, CHINA
Beijing +8610-6561-6561 ext 8908, Shanghai +8621-6350-0888 ext 1297,
Guangzhou +8620-8666-9888 ext 6406, Shenyang +8624-2281-2988 ext 4016.
KODAK (HONG KONG) LIMITED. Document Imaging, Taikoo Shing HONG KONG +852-2564-9330
KODAK INDIA LIMITED. Document Imaging, INDIA
Chennai +91-44-2362-1203, New Delhi +91-11-2338-5471, Mumbai +91-22-5641-6751
KODAK (KOREA) Limited. Document Imaging, Seoul, KOREA +82-2-708-5549
KODAK (MALAYSIA) SDN BHD. Document Imaging, Selangor MALAYSIA +603-7957-2722 ext 1381
KODAK (PHILIPPINES) LIMITED. Document Imaging, Makati City PHILIPPINES 1299 +632-810-0331 ext 322
KODAK (SINGAPORE) PTE. LTD. Document Imaging, SINGAPORE 098632 +65-6371-3168
KODAK TAIWAN LIMITED. Document Imaging, Taipei TAIWAN 112 +886-2-2316-8188
KODAK (THAILAND) LIMITED. Document Imaging, Bangkok THAILAND 10400 +662-271-304-059 ext 404
In other areas of Asia, contact Kodak via email: marcom@kodak.com